



# START UP GUIDE

## 2100/2101 VE SWIM SPAS

### PREP FOR FILLING

**! PLEASE READ ALL INSTRUCTIONS BELOW BEFORE FILLING THE SPA**



Using a cloth and water, wipe away any dirt/dust collected from transport. Ensure all jets are open by turning the face counter clockwise.



If your spa has a Crystal Clear tube the threaded plug needs to be on prior to filling the spa.



Remove the filter lock ring and lid. Remove filter and take it out of the plastic transport bag.



Put the filter back inside and secure the lid firmly with the locking rig. Loosen air-bleed screw.

### FILLING YOUR SPA

**! DO NOT USE HOT WATER TO FILL YOUR SPA**

**! DO NOT USE WATER FROM A WATER SOFTENER**



Place fill hose inside the spa and fill main body of spa with water until it reaches the infinity edge. Allow water to spill over infinity edge for approximately 60 seconds.

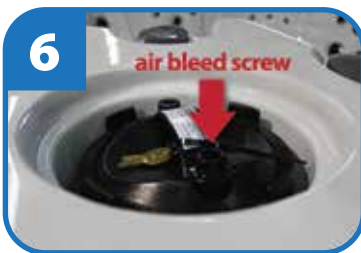

Tighten air-bleed screw.



Turn power to the spa on from GFCI breaker to activate water level gauge. Continue filling until the water gauge reads just above 3/4 full.



Turn power to the spa off from the GFCI breaker for 30 seconds and then turn back on.



Press the return/pump 5 button to exit the priming mode, pump 1 will automatically start. Turn pump 1 off by pressing the pump 1 button twice.

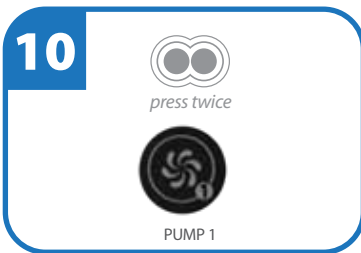

Turn pump 2 on; once pump 2 is running make sure all the air is removed from the check valve. Press the pump 1 button twice to turn pump 1 into high speed. The check valve will pull air in. You will then turn pump 1 off.

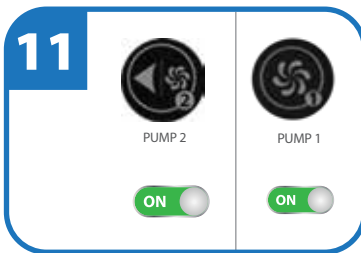

Continue running pump 2, once the check valve is full of water turn pump 1 onto high speed by pressing the pump 1 button twice, then turn off by pressing pump 1 once. Repeat this step 3-4 times until all the air is removed from the check valve.



Cascade check valve inside the equipment area, full of water is an indication of no more air in the plumbing line. If the check valve is not full of water, air is still in the plumbing lines.



Release any additional trapped air by loosening the air bleed screw. Wait for all air to be released. Retighten.

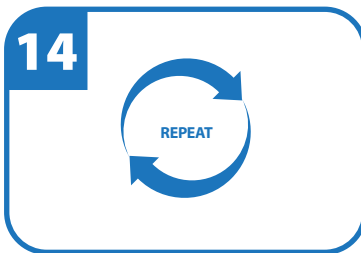

Repeat steps 11-12 until all air has been removed from the system. If air is still in the system it will precede water coming out of the jets when pump 1 is activated.

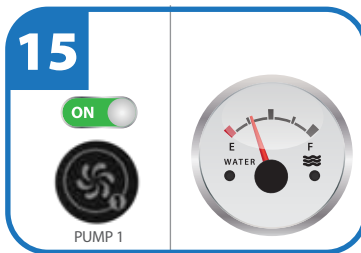

Your water level should read just above 1/4 on the gauge when pump 1 (high speed) is activated. **Your hot tub is now filled. Set the temperature and get ready to enjoy!**